

LOWER LEVEL 1,515 SQ. FT.

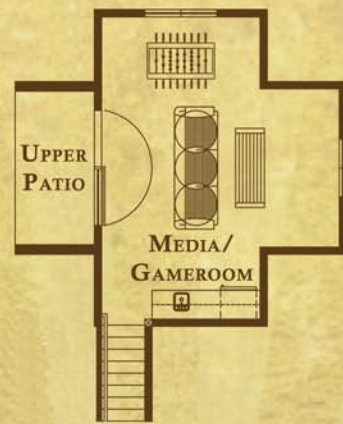

UPPER LEVEL
OPTION "A" 430 SQ. FT.



UPPER LEVEL
OPTION "B" 430 SQ. FT.

the **MARIAS**
+ BONUS ROOM

LIVING AREA 1,945 SQ. FT.
GARAGE / MECHANICAL 553 SQ. FT.

- ① PATIO 10' x 14'
- ② TWO CAR GARAGE 24' x 21'
- ③ DINING 14'-6" x 10'-4"
- ④ MUDROOM 8'-6" x 6'-9"
- ⑤ MASTER SUITE 15' x 12'-2"
- ⑥ KITCHEN 14' x 10'-8"
- ⑦ UTILITY 6'-6" x 8'
- ⑧ BATH 10'-6" x 10'-6"
- ⑨ BATH 8'-8" x 5'
- ⑩ LIVING ROOM 15' x 17'
- ⑪ ENTRY 9'-6" x 9'-10"
- ⑫ WALK-IN CLOSET 8'-4" x 5'
- ⑬ COVERED PORCH 22' x 8'
- ⑭ OFFICE/GUEST SUITE 13' x 13'-6"
- ⑮ OPTIONAL SPA



HOME SIZE:

- TWO BEDROOM SUITES/THREE BATHS
- ONE OFFICE/GUEST SUITE
- TWO CAR GARAGE

MARIAS GENERAL SPECIFICATIONS:

DESIGNED BY AWARD WINNING WESTERN ARCHITECT JERRY LOCATI

INTERIOR:

- WIDE-PLANK WOOD FLOORS
- NATURAL SLAB STONE COUNTERTOPS IN KITCHEN AND BATHS
- KNOTTY ALDER PLANK DOORS
- EXPOSED HEAVY TIMBER BEAMS AND TRUSSES
- KNOTTY ALDER WOOD TRIM
- GOURMET KITCHEN APPLIANCES
- 90% EFFICIENT GAS FURNACES
- GAS FIREPLACE IN LIVING ROOM
- CUSTOM CABINETRY THROUGHOUT HOME
- AIR-CONDITIONING READY

EXTERIOR:

- NATURAL WOOD SIDING AND SHAKES
- CUSTOM WOOD OVERHEAD GARAGE DOORS
- VERTICAL BOARD AND BAT
- COR-TEN® METAL AND ASPHALT SHINGLE ROOFING
- RAIN CHAIN GUTTER DOWNSPOUTS
- OPTIONAL OUTDOOR FIREPLACE
- OPTIONAL SPA

SITE FEATURES / ZERO MAINTENANCE PROGRAM:

- OPTIONAL PIGMENTED AND STAMPED CONCRETE PATIOS
- PROFESSIONALLY DESIGNED AND INSTALLED IRRIGATION/LANDSCAPING
- FENCED REAR YARD PATIO WITH OPTIONAL HOT TUB AND OUTDOOR FIREPLACE
- FULLY MAINTAINED LANDSCAPING
- SNOW REMOVAL OF DRIVEWAYS, WALKS AND PATIOS

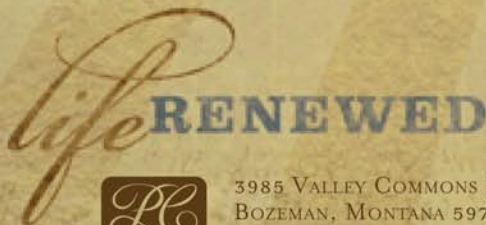

3985 VALLEY COMMONS DRIVE
BOZEMAN, MONTANA 59718
PH 406.586.9922 • F 406.586.9921



MARIAS

+ BONUS ROOM

MARIAS + BONUS ROOM GROSS SQUARE FOOTAGES

TOTAL FIRST FLOOR	1,515 SQ. FT.
TOTAL SECOND FLOOR	430 SQ. FT.
TOTAL FINISHED LIVING	1,945 SQ. FT.
TOTAL GARAGE	553 SQ. FT.

*BONUS ROOM OPTION AVAILABLE ON
LOTS 1,5,8,9,12 & 16 OF BLOCK 3